User Guide

V12 May 2014

APU150/350/550

High Pass Filter Protection Unit



APU150/350/550

These protection units have been designed specifically to enhance the reliability of your Evolution Series loudspeaker. They feature a high pass filter and a current sensing fuse to protect the loudspeaker from being over-driven and potentially damaged. If the protection unit senses excessive drive current from your amplifier, it will automatically reduce the sound level from the speaker until the amplifier volume is reduced to a safe level.

Please read this document carefully before operating your loudspeaker and protection unit.



IMPORTANT:

- Ensure that the correct model APU is used with the loudspeaker. Failure to do so may result in speaker damage. See the label on the underside of the APU for model designation (see next page).
 - NEVER connect more than one loudspeaker to each output channel.
 - Be sure that all connections are made in accordance with this guide.
 - It is not recommended you use amplifiers with power outputs greater than the peak power rating of the loudspeaker.
 - Do not intentionally cause the APU to go into protection mode by deliberately over-driving the loudspeaker.
 - If your APU automatically reduces the audio volume from the loudspeaker frequently, it may suggest the amplifier is too powerful or the layer of plaster applied to the Evolution Series loudspeaker is too thick. In either case please consult with your dealer or Amina Technologies Ltd.
 - Install this product in a cool, dry and clean place - away from direct sunlight, heat sources, vibration, dust and moisture.
 - Do not expose this unit to sudden temperature changes or locate it in an environment with high humidity. This is to prevent condensation forming inside which may cause damage to the unit and possibly other devices connected to it.
 - Do not clean this unit with chemical solvents as this may damage the finish. Use a clean, dry or damp cloth.
-

Positioning

- The APU150, APU350 and APU550 are designed to be free-standing or permanently fixed to a suitable structure using the two mounting holes.
- They do not require ventilation and therefore their installation position is not critical. However, the product should ALWAYS be installed in a dry environment that will not exceed 35 degrees Centigrade (95 degrees Fahrenheit).
- Do not place equipment on top of the APU.
- Where possible, do not position the APU adjacent to mains power cables.

Speaker model compatibility

Only use the APU model with the Evolution Series speaker it is designed for.

APU150: AIW150E, AIW150E/ S200
APU350: AIW350E, AIW350E/ S200
APU550: AIW550E



WARNING:

Failure to use the correct model can result in damage to the loudspeaker.

Connecting

Wiring schematic

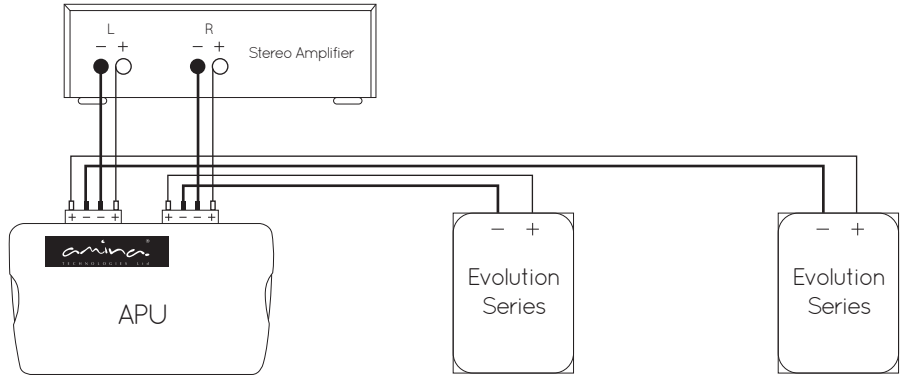

Note:

Red levers on the Springcon® plugs are used for the "+" loudspeaker connections.

Black levers on the Springcon® plugs are used for the "-" loudspeaker connections.

Springcon® plugs connection

Note:

Ensure the cables are securely clamped when the Springcon® levers are closed.

To remove the plugs from the connecting header squeeze the two clips on either side to release.

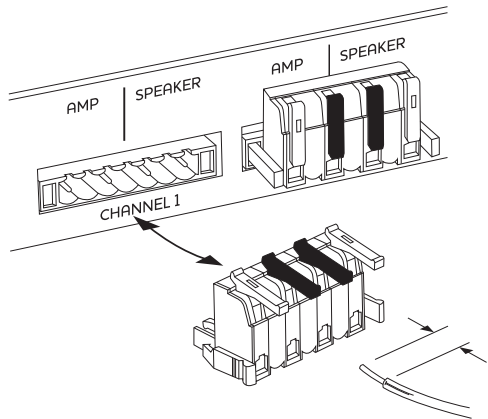

Strip cable back by 6 - 8mm
(1/4" - 5/16")



WARNING: Always switch your amplifier off whilst connecting / disconnecting speakers

Specifications

Model Number	APU150	APU350	APU550
Dimensions	190 x 100 x 42mm (7½ x 4 x 1⅝")		
Weight	0.25kg	0.25kg	0.28kg
Filter type	Passive 1st order high pass with EQ	Passive 1st order high pass	Passive 1st order high pass with EQ
Fuse protection	Self-resetting, current sensing type		
Compatibility	AIW150E, AIW150E/S200	AIW350E, AIW350E/S200	AIW550E
Number of channels	2	2	2
Connection type	1x Springcon® 4 pole connector per channel. Connector carries input and output for each channel		
Maintenance requirements	Repeated tripping of fuses may require fuse replacement by the manufacturer to ensure optimal speaker performance		

Dimensions

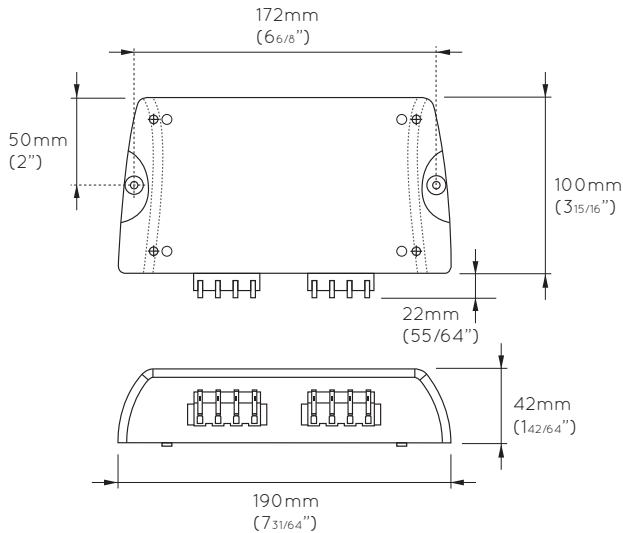

Contact information

Amina Technologies Ltd (UK)

Cirrus House, Glebe Road, Huntingdon

Cambridge, PE29 7DL, UK

T: +44 (0) 1480 354390

E: inspired@amina.co.uk

W: www.amina.co.uk

US

Amina Technologies Ltd

P: 1-866 462 6462

E: sales@aminatechnologies.com

W: www.aminatechnologies.com



Amina Technologies Ltd
Cirrus House, Glebe Road, Huntingdon, Cambs,
PE29 7DL England
T: +44 (0) 1480 354390
W: www.amina.co.uk
E: inspired@amina.co.uk
