

Installation Guide

V1.4 July 2013

BackboxSW

345/300/200

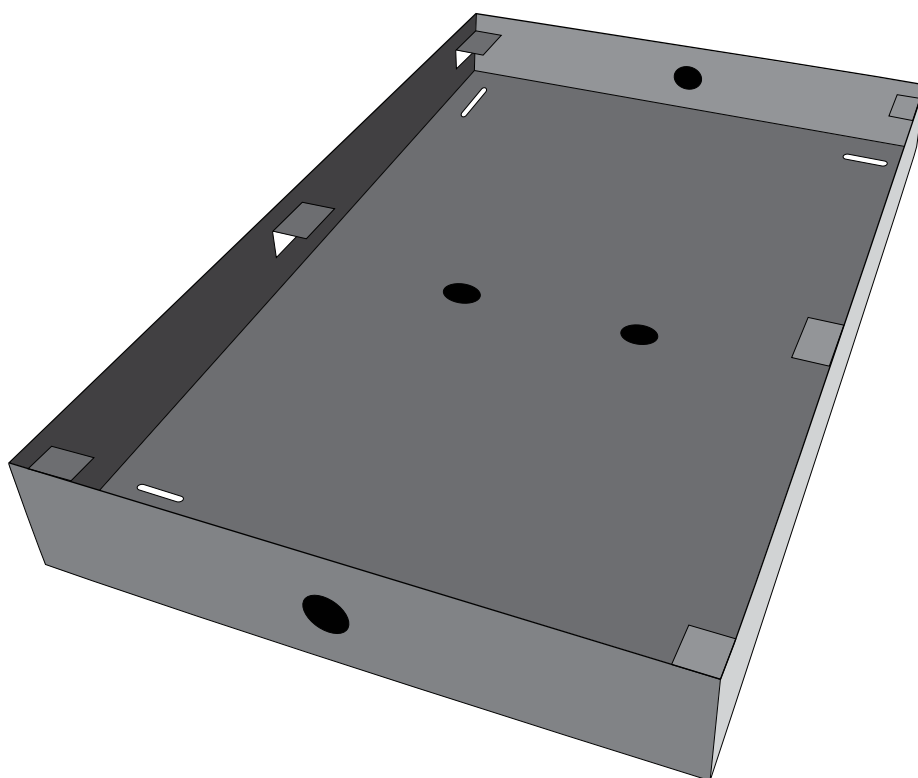

Caution: Read before installing this product

- To ensure correct installation, please read this guide carefully and keep in a safe place for future reference.
- Install this product in a cool, dry, clean place - away from direct sunlight and heat sources, vibration, chemical fumes, dust and moisture (steam).
- Do not clean this product with chemical solvents as this may cause damage to the finish. Use a clean, dry or damp cloth.
- Ensure that all installation mounting surfaces are able to support the weight of the BackboxSW with that of your chosen speaker.
- Do not attempt to modify or repair the product. Contact your distributor or manufacturer if it is faulty or damaged in any way.



ENVIRONMENTAL:

Please be aware that whilst this product reduces the rearward sound output of the loudspeaker some vibrational energy may still travel some considerable distance up, down and along the wall or ceiling structure. It is therefore recommended the product be fitted in conjunction with vibration absorbing materials to minimise these effects.



WARNING:

No attempt should be made to install this product within existing building structures unless you are certain that no electric cables, water pipes, gas pipes or supporting joists will be cut through.



Contents

- 01 Packaging / Introduction / Overview
- 02 Installation steps 1 + 2
- 03 Installation steps 3, 4 + 5
- 04 Alignment for feathered skim
- 05 Alignment for patch plastering
- 06 Alignment for full wet skim
- 07 Further details
- 08 Warranty, copyright, contact information



Packaging

**CAUTION:**

Take care when removing the BackboxSW from the carton.

The packaging for the BackboxSW has been carefully designed to protect the product during transit. Please retain it in the unlikely event you need to return the product to your dealer or manufacturer. Please recycle the packaging should you wish to dispose of it.



The BackboxSW outer carton is made up of 80% recycled single wall board.

Introduction

Thank you for purchasing the Amina Technologies BackboxSW. This product has been designed for the installation of Amina Series Invisible Loudspeakers into solid (eg. brick, concrete) walls and ceilings. Constructed from zintec steel, the BackboxSW is rugged enough to be installed early in the build process.

Installation is simple however, please follow this guide carefully as it contains important advice on speaker alignment for plastering and reducing structural energy transference.

Overview

- ① Rubber grommets
- ② Backbox mounting slots 
- ③ Speaker mounting tabs 

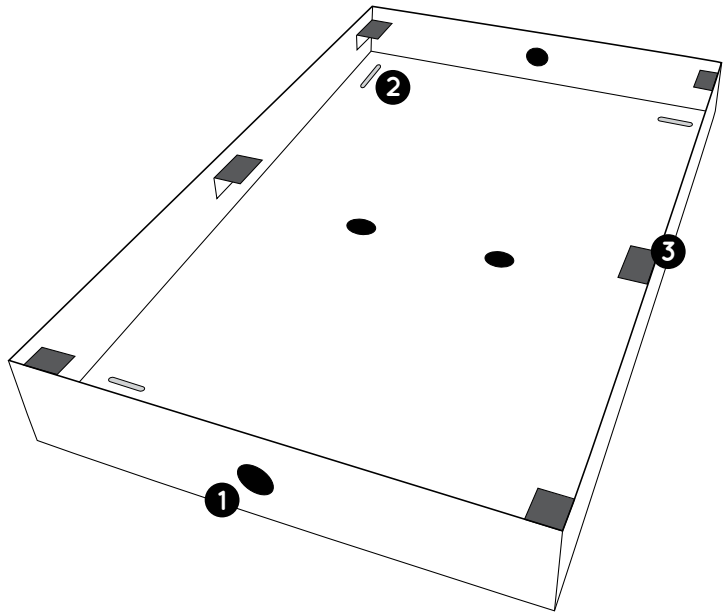

Part Numbers

BackboxSW345 - Evolution Series

BackboxSW300 - iQ Series/ LFieT Series

BackboxSW200 - Evolution "S200" models and AIW750E - HF Panel

BackboxSW installation

01 Create aperture in brickwork / concrete

Check which version of the BackboxSW you have before following this section.

Create 460mm x 205mm (18.1" x 8.1") aperture. (SW200)

Create 460mm x 305mm (18.1" x 12") aperture. (SW300)

Create 460mm x 450mm (18.1" x 13.8") aperture. (SW345)

Using the combination of an angle grinder and a jackhammer drill, create a cavity within the brickwork.

Before installing the BackboxSW you will need to know the thickness of render that will be applied to the wall/ceiling prior to the finish plaster skim.

Minus this thickness from 50mm (2") to calculate the minimum cavity depth you will need to create in order for the BackboxSW to fit.

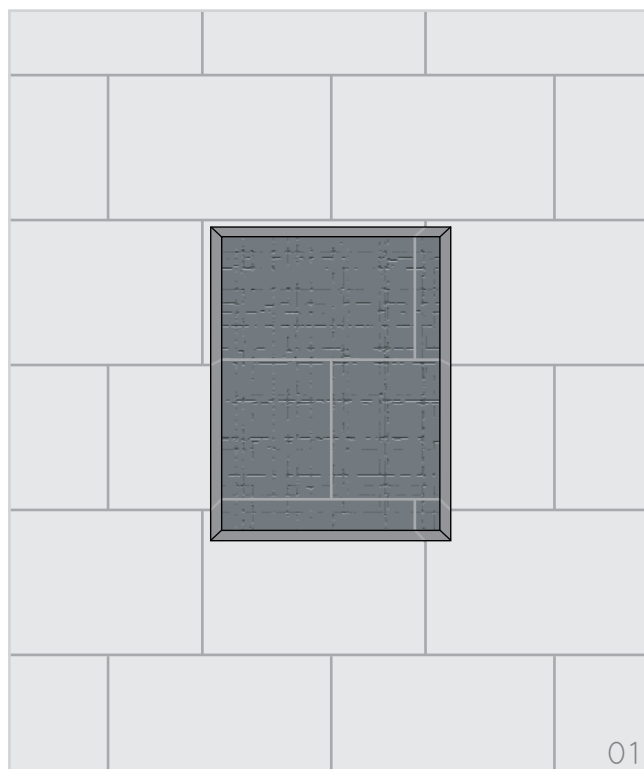

02 Create channel for cable

Using an angle grinder or hammer and chisel, create a channel that runs into the cavity. This will allow the speaker cable to be pulled into a suitable position within the cavity.

We recommend the cable is run in a suitable conduit to protect it.

Leave enough cable slack to allow connection to the speaker when it is held away from the cavity.

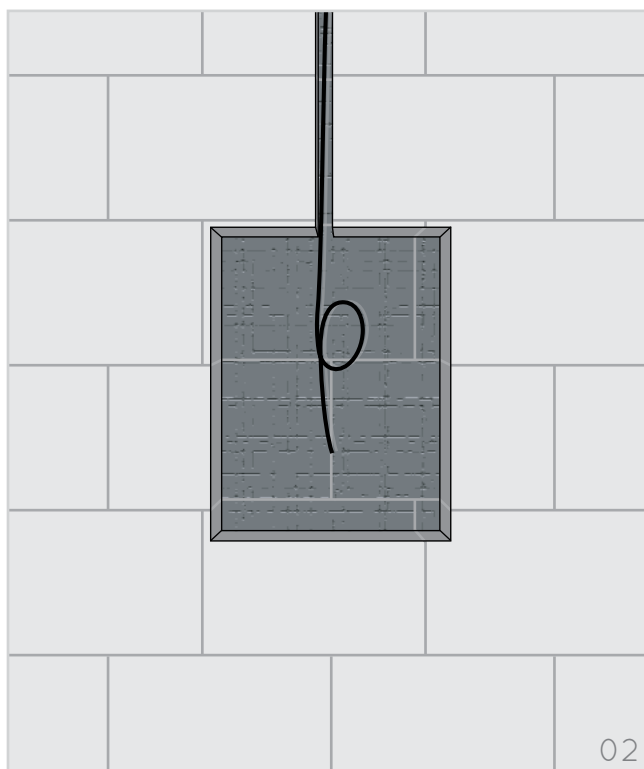

BackboxSW installation continued...

03 Install BackboxSW

Make a small hole in one of the rubber grommets and pull the speaker cable through it and into the BackboxSW. There are four slots in the base of the BackboxSW and using suitable screws (not supplied), fix the BackboxSW to the brickwork/concrete within the cavity. Ensure the front edge of the BackboxSW aligns flush with the front face of the surface which will be plaster skimmed. Shims may be fitted behind the BackboxSW to achieve a level solid fixing.

It is recommended to add sound absorbing mineral wool (1" maximum thickness) to the inside of the BackboxSW and expanding foam around the sides to prevent resonance.

NB: If there is a layer of render to be applied or already applied to the brickwork, be sure to align the front edge of the BackboxSW to the front edge of the render (as shown in the lower section of the image)

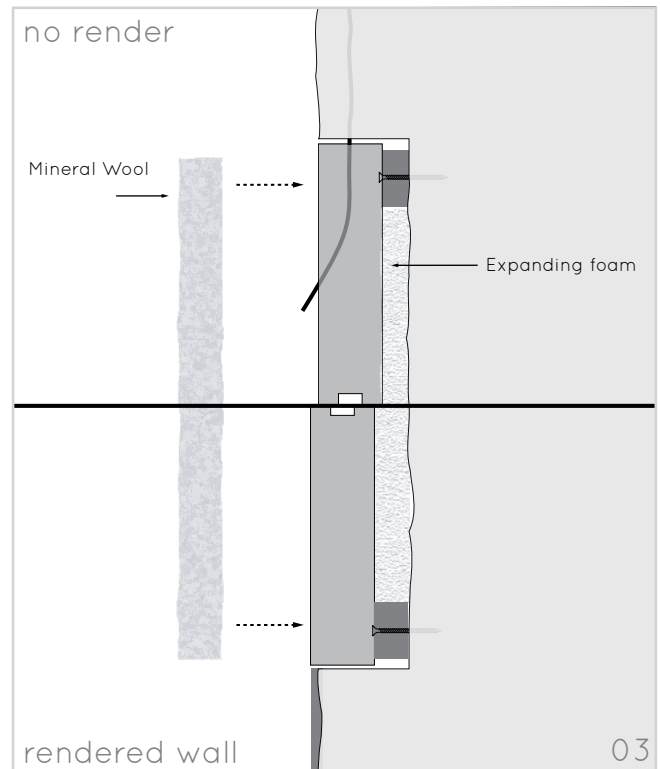

04 Fixing the speaker to the BackboxSW

Once the speaker has been electrically connected it can now be fixed to the BackboxSW.

Remove the backing paper from the 6 adhesive pads on the speaker mounting tabs **3** and carefully position the speaker onto the mounting tabs then apply moderate pressure. There should be an equal perimeter gap between the BackboxSW and the edge of the speaker.

Use the flange head screws (supplied with the BackboxSW) to fix the corners of the speaker to the four corner mounting tabs.

05 Testing and plastering

Speaker testing should always be done before plastering. Please refer to the loudspeaker's installation guide for testing information and for details on how to plaster your loudspeaker after you have installed the BackboxSW.

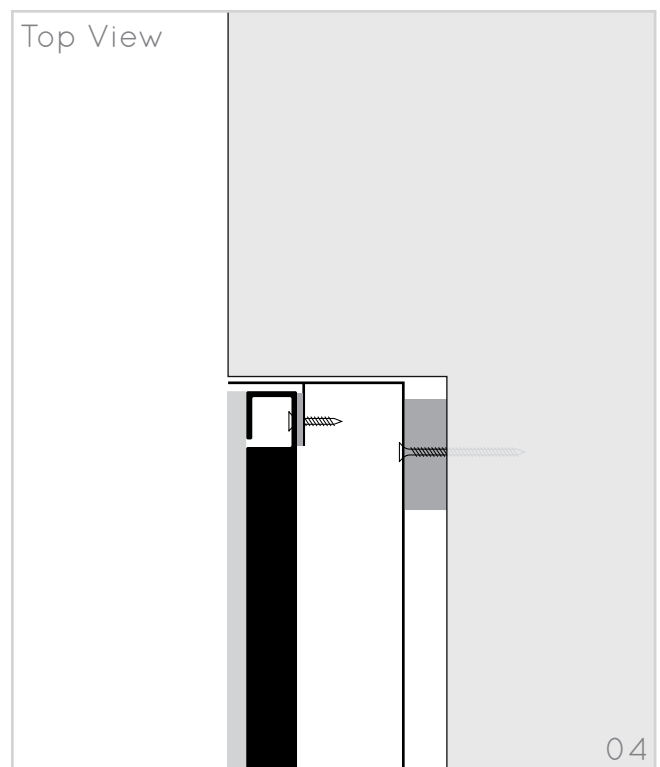

Retrofit / pre-skimmed solid wall Feathered skim finish

For solid walls / ceilings that have already been plastered and painted.

Backbox alignment required for plastering

Use shims between the back of the BackboxSW and the inside of the cavity to align the front edge of the BackboxSW with the front face of the finished wall.

This method positions the speaker for a large area (approx. 1m² (39'')) to be skimmed over it. This 2mm (5/64'') thick skim is then feathered outward at the edges and blended into the existing wall/ceiling finish.

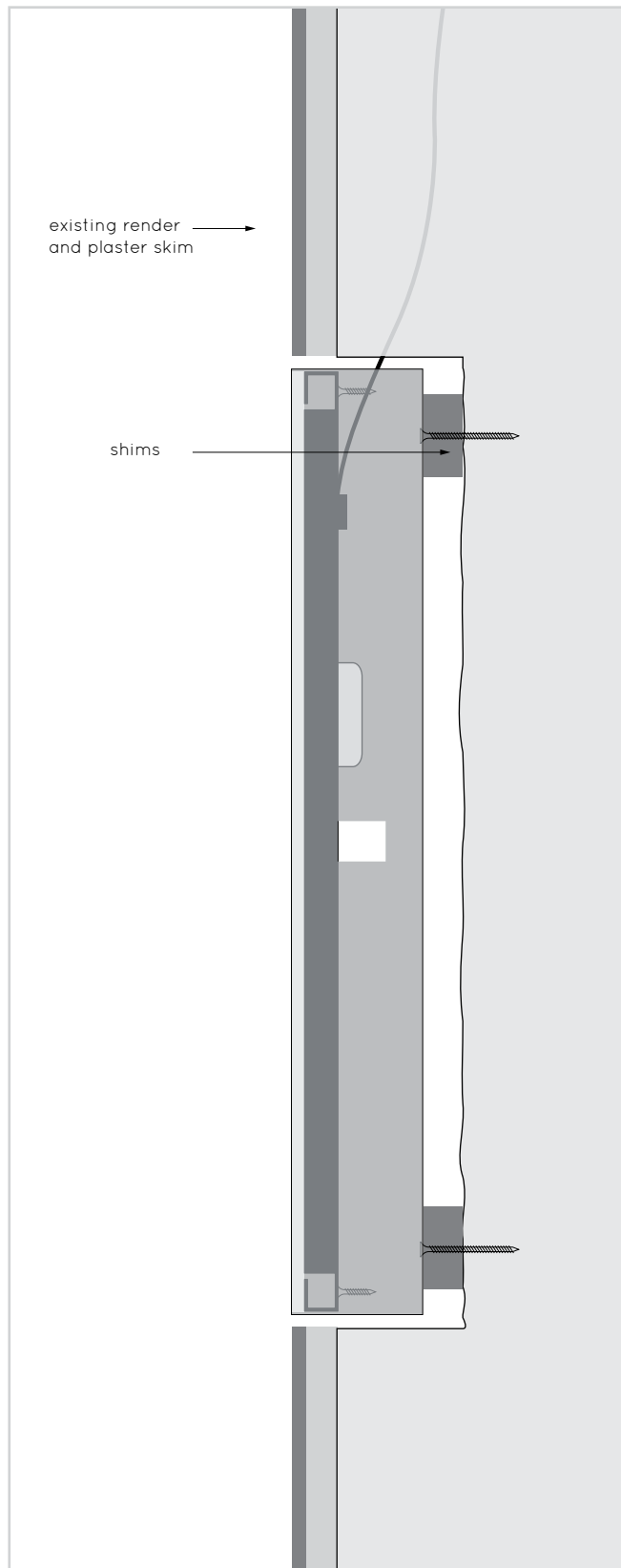

Retrofit / pre-skimmed solid wall

Patch plaster finish (alternative to feathered skim)

For solid walls / ceilings that have already been plastered and painted.

Backbox alignment required for plastering

Use shims between the back of the BackboxSW and the inside of the cavity to align the front edge of the BackboxSW with the front face of the base render. This should be no more than 2mm (5/64") behind the finished plaster surface.

This method positions the speaker to be patch plastered with a 2mm (5/64") skim across the speaker front and blended with the existing plaster.

Amina recommend British Gypsum Easi-fill® which allows a smooth accurate finish using fine sandpaper or a wet sponge.

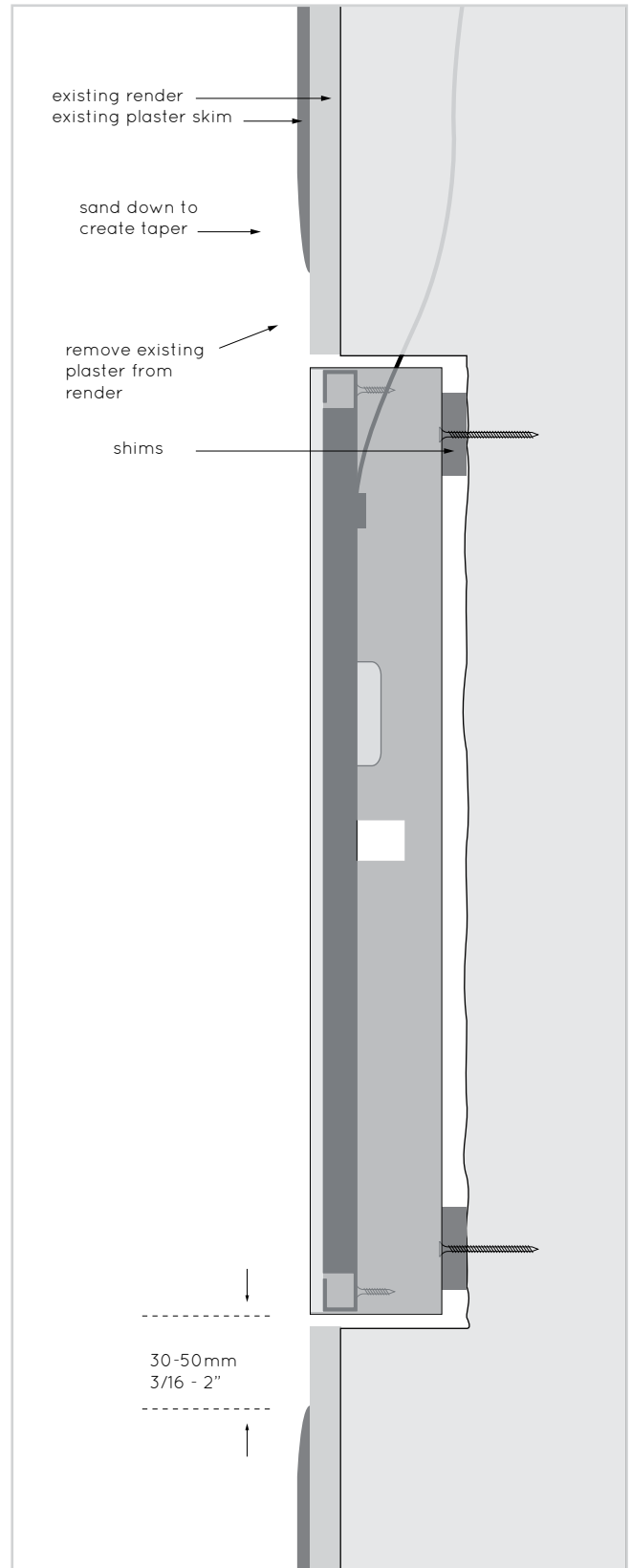
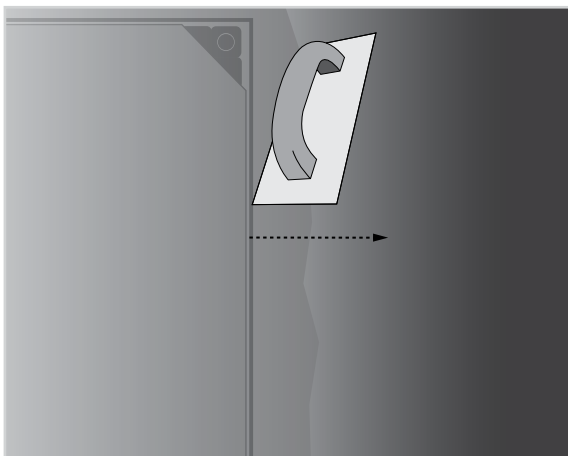

New Build / new solid wall

Full wet skim finish

For solid walls / ceilings that have already been rendered but not yet plaster skimmed.

Backbox alignment required for plastering

Use shims between the back of the BackboxSW and the inside of the cavity to align the front edge of the BackboxSW with face of the rendered wall.

This method allows the speaker to be skim plastered over during the process of the entire wall/ceiling being plastered - 2mm maximum.

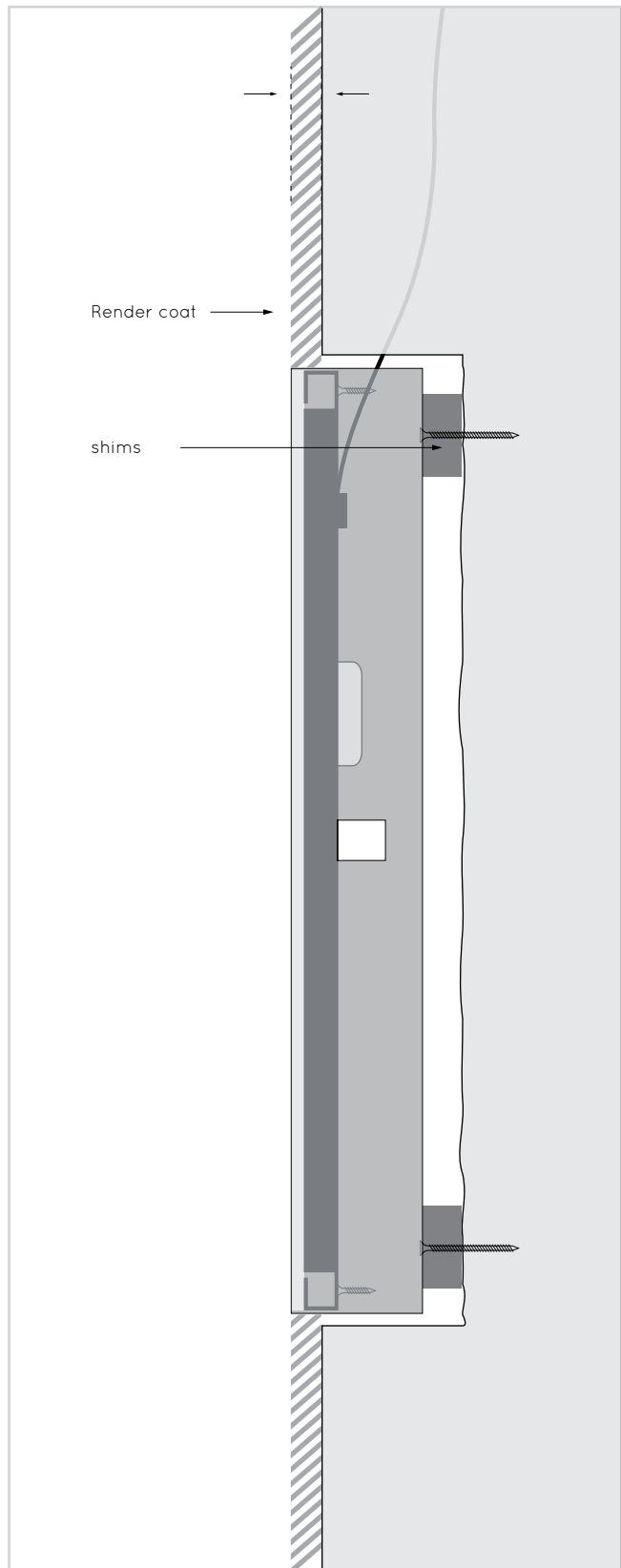
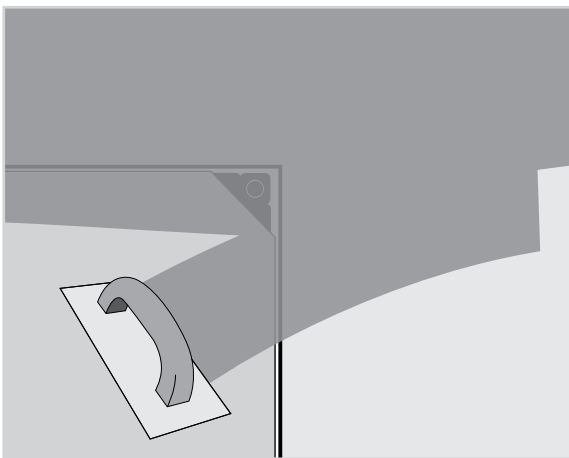

Further details

Removal

In the unlikely event of a problem developing with the product, or you simply wish to remove the item to change its location, please refer to the following guidelines:

Locate the speaker by tapping the wall or ceiling listening for a hollow sound compared to the rest of the wall/ceiling. Then, with a sharp chisel or decorator's scraper, carefully chip into the plaster to expose a small area of the panel surface. To ensure you do not damage the panel, hold the tool at an acute angle to the wall or ceiling.

Now, holding the scraper almost parallel to the panel surface, work outwards towards the product's edge easing the plaster away from the panel. Do not worry if the panel surface receives marks or indented scratches during this process (it should not, however, have holes entering through to the unique honeycomb panel). Once the product is plastered back into its original or new location, the new skim of plaster will cover all these imperfections and the speaker's performance will not be unduly affected.

Clear the surface plaster material from the surrounding area of wall or ceiling to expose all the joint tape and subsequently remove it. Use a narrow chisel or flat blade screwdriver to remove the plaster and expose the screws at each corner of the speaker. Using a suitable screwdriver, remove the four screws and then ease the speaker from the wall or ceiling and disconnect the speaker cable.

Next locate the screws fixing the BackboxSW to the wall/ceiling and carefully remove them. Cut away any expanding foam from around the sides of the BackboxSW with a sharp knife and pull the BackboxSW out of the cavity.

If any products become damaged when removing, please return them to Amina Technologies Ltd where the product can be repaired or replaced.

Warranty information

Limited Warranty:

The Amina BackboxSW is designed to last for many years. Correctly installed in accordance with these instructions, Amina warrants the BackboxSW against defective materials and workmanship for a period of five years in commercial applications and ten years in residential applications.

At the end of the product's useful life it should be returned to your supplier, or directly to Amina for recycling. If you have any questions please contact Amina Technologies Ltd.



* Please refer to our full warranty statement for details, available on our websites, or alternatively contact us via email on any of the above addresses.

Important Note: This product does not comply to European Construction Products Directive EN 54-24 and therefore must not be used in European voice evacuation systems.

Copyright information

This document is Copyright of Amina Technologies Ltd, 2013
 Easi-fill is a registered trademark of British Gypsum Ltd
 Amina is a registered trademark of Amina Technologies Ltd

Contact information

Amina Technologies Ltd (UK)

Cirrus House, Glebe Road, Huntingdon
 Cambridge, PE29 7DL, UK
 T: +44 (0) 1480 354390
 F: +44 (0) 1480 356564
 E: inspired@amina.co.uk
 W: www.amina.co.uk

Corporate Office North America

Amina Technologies NA Ltd

286 Columbus Road East
 Oshawa, Ontario L1H7K4
 Direct 1-905 655 6411
 Toll free 1-866 462 6462
 Toll free Fax 1-888 329 2491

E: sales@aminatechnologies.com
 W: www.aminatechnologies.com



Amina Technologies Ltd
Cirrus House, Glebe Road
Huntingdon, Cambs, PE29 7DL England
T: + 44 1480 354390 / F: + 44 1480 356564
